

# Thompson Retractor

Uncompromised Exposure™

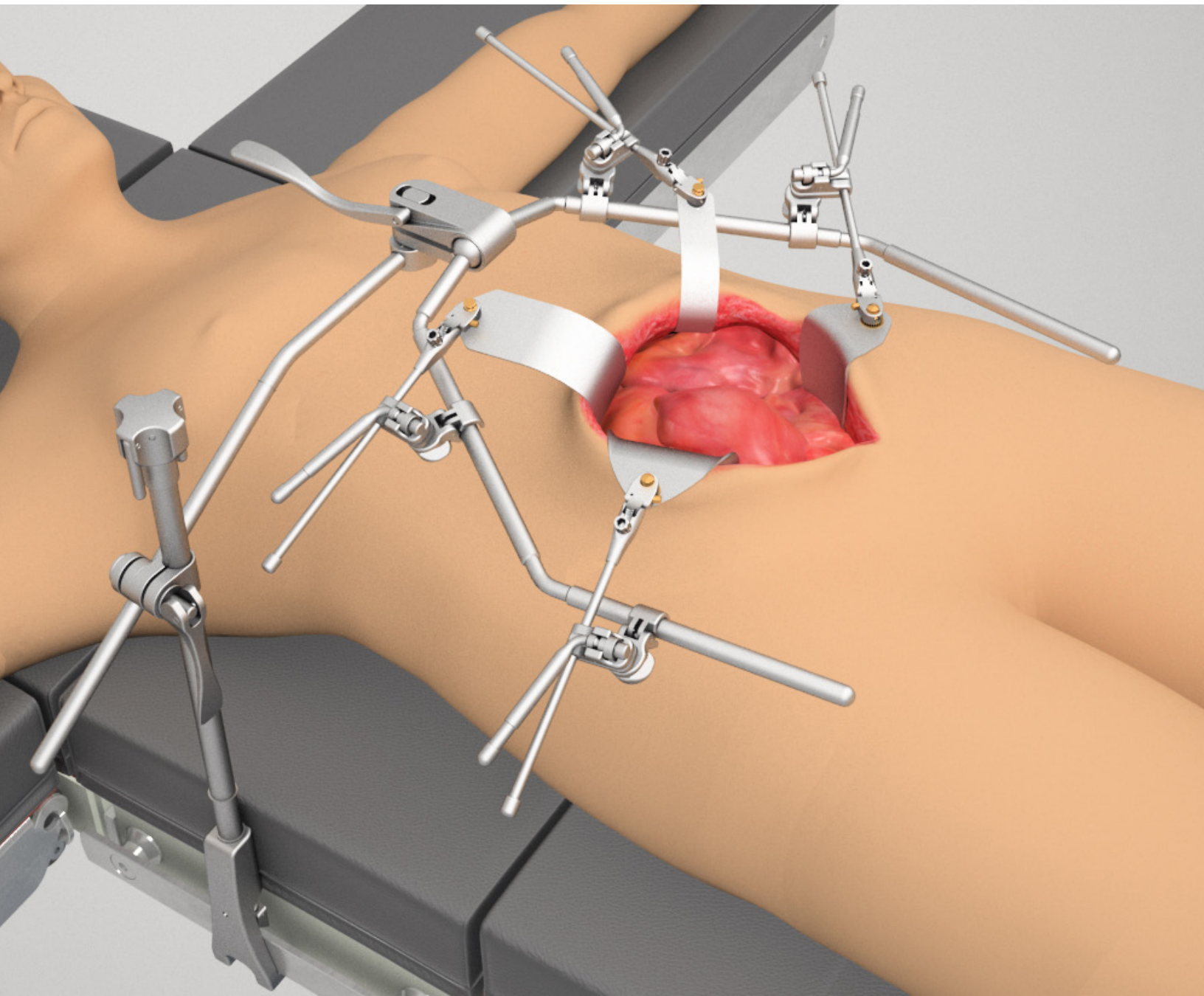



**Thompson OneFrame™ User Manual:**

**SET UP INSTRUCTIONS FOR THOMPSON ONEFRAME™**

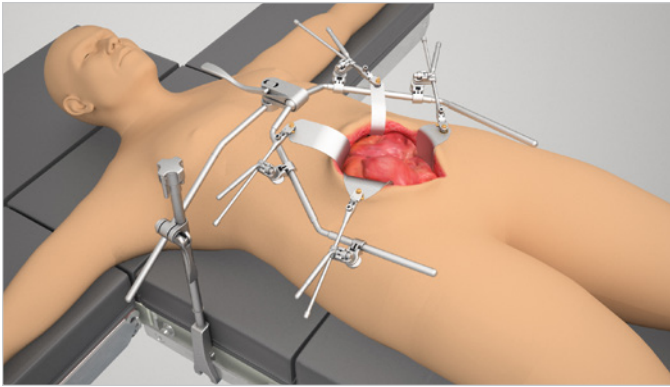
## OneFrame™ Set Up Instructions



-  **CAUTION:** Avoid compressing the patient's body with frame components to prevent nerve damage.
-  The Thompson Retractor is provided in a non-sterile condition. Refer to Thompson Retractor IFU for cleaning, sterilization, and care instructions.  
Reference the Thompson Retractor IFU for additional warnings and cautions.  
For other Thompson Retractor Systems, reference corresponding User Manual for each.

### STEP 1: RAIL CLAMP

Place Elite Rail Clamp onto the rail over the sterile drape and turn top knob clockwise to tighten.



### STEP 2: ATTACH ONEFRAME™ TO ELITE RAIL CLAMP

Insert OneFrame™ support arm into joint on the Elite Rail Clamp, position as desired, and flip cam joint handle to secure in place.



## OneFrame™ Set Up Instructions ( Continued )

### STEP 3: ONEFRAME™ ARMS

With the OneFrame™ joint in the unlocked position, adjust frame arms as desired. Lock into place by flipping joint 180° ( pointing away from arms. )

**NOTE: To avoid damage to the product, DO NOT move frame arms with the frame joint in the locked position.**

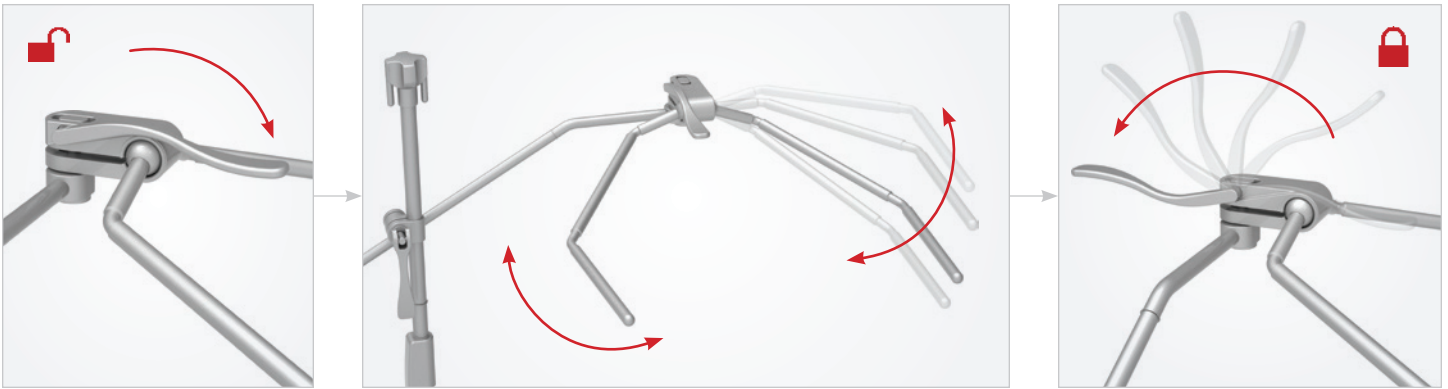

## Handles + Blades

### CLIP-ON HANDLE ATTACHMENT

With joint in unlocked position, clip to frame in desired location, position blade in the incision, and flip the cam joint handle to lock in place.

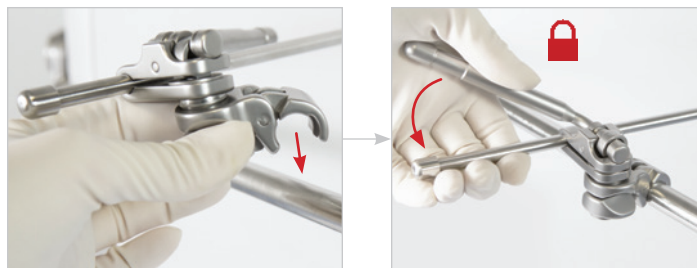

### CLIP-ON HANDLE REMOVAL

Flip cam joint handle to unlocked position, pinch back of cam joint with thumb and index finger, and gently lift up off of arm.

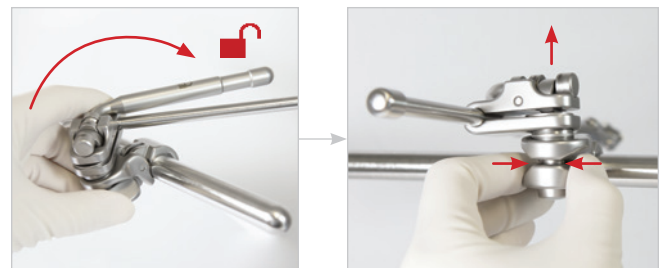

### S-LOCK® HANDLES + BLADES

Attach blade to handle by pushing plunger and inserting blade nipple. Push plunger to release blade and switch between 'swivel' and 'locked' positions.

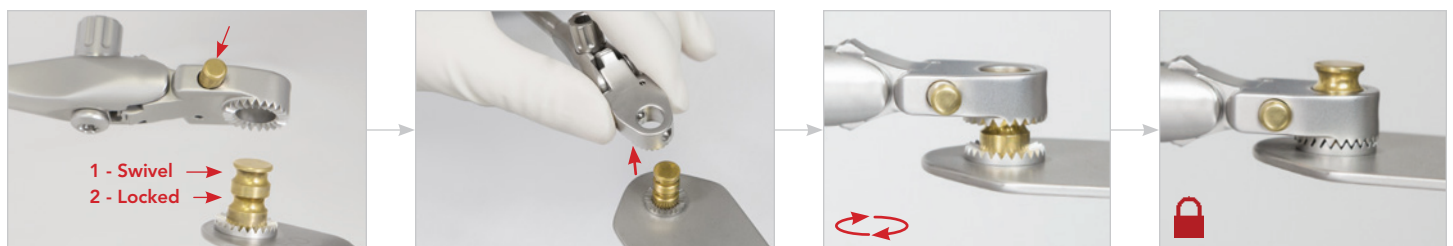

### QUICK ANGLE HANDLES

Blades may be angled 45° up or down by hand or with T-Handle.

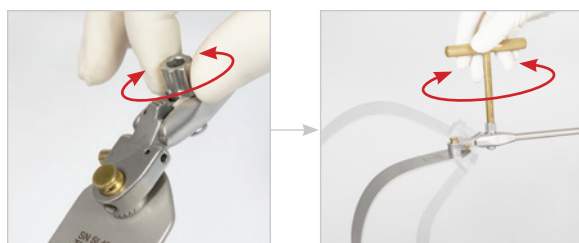

### MICRO-ADJUSTABLE HANDLES

Retract blades further by turning the Micro-Adjustable Handle knob clockwise. Release tension by pressing the pawl.

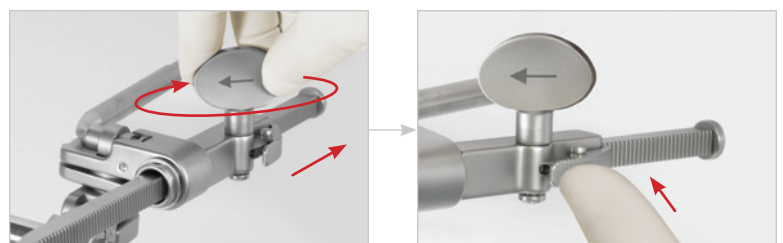

For a Free Trial Call Today\*

**1.800.227.7543**

Rev B  
042921  
dc tofum



Uncompromised Exposure

VISIT US ONLINE: [THOMPSONSURGICAL.COM](http://THOMPSONSURGICAL.COM)



**Thompson**  
SURGICAL INSTRUMENTS

10341 East Cherry Bend Road  
Traverse City, Michigan 49684  
phone: 231.922.0177  
fax: 231.922.0174  
[thompsonsurgical.com](http://thompsonsurgical.com)

EC REP

**Emergo Europe**

Prinsessegracht 20  
2514 AP The Hague  
THE NETHERLANDS

\* Free trial valid for U.S. customers only. Customers outside U.S. please call +1-231-922-0177 for availability.

© 2020 Thompson Surgical Instruments, Inc.

© S-Lock®, PLA®, and the "T Circle" logomark are Registered Trademarks of Thompson Surgical Instruments, Inc.

™ OneFrame™ is a Trademark of Thompson Surgical Instruments, Inc.

Patents: [trpat.com](http://trpat.com)

**Symbol Legend:**

 Manufacturer	 Authorized EC Rep	 CE Mark	 Warnings / Precautions	 Non-Sterile
---	--	--	---	--

CE 0297

Made In  
USA