

Open Posterior Lumbar System COMPONENTS

Open Posterior Lumbar Set Up

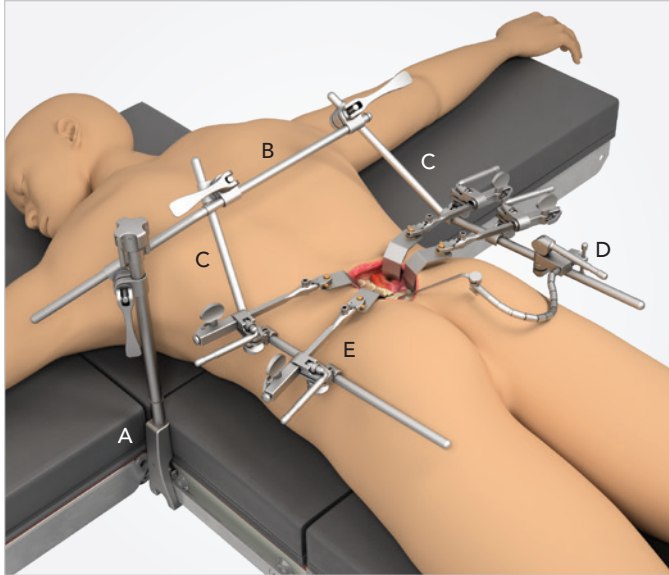

POSTERIOR LUMBAR SYSTEM

#SL82020

REF	PART #	ITEM DESCRIPTION	QTY
Tray 1			
A	43902ACL	Elite III Rail Clamp with 1 Cam Joint 16"	1
B	43900BC	Crossbar w/2 Cam Joints 24" (11" x 13")	1
C	44124N	24" Angled Arm (8" x 16") @ 45°	2
D	42140C	Flexible Blade Holder with Cam Joint	1
E	SL45011CGP	Mini Micro-Adjustable II Clip-on Quick Angle 9"	4
F	60020	T-Handle	2
	50000G	Instrument Case (23" x 11" x 3 1/2")	1
Tray 2			
G	SO45670ATTC	Radiolucent Concave Posterior Lumbar 23mm x 80mm (1" x 3 1/8")	2
H	SO45671ATTC	Radiolucent Concave Posterior Lumbar 45mm x 80mm (1 3/4" x 3 1/8")	2
I	SO45672ATTC	Radiolucent Concave Posterior Lumbar 60mm x 80mm (2 3/8" x 3 1/8")	2
J	SO45673ATTC	Radiolucent Concave Posterior Lumbar 23mm x 100mm (1" x 4")	2
K	SO45674ATTC	Radiolucent Concave Posterior Lumbar 45mm x 100mm (1 3/4" x 4")	2
L	SO45675ATTC	Radiolucent Concave Posterior Lumbar 60mm x 100mm (2 3/8" x 4")	2
M	SO45676ATTC	Radiolucent Concave Posterior Lumbar 23mm x 120mm (1" x 4 3/4")	2
N	SO45677ATTC	Radiolucent Concave Posterior Lumbar 45mm x 120mm (1 3/4" x 4 3/4")	2
O	SO45678ATTC	Radiolucent Concave Posterior Lumbar 60mm x 120mm (2 3/8" x 4 3/4")	2
P	45752A	Nerve Root Retractor 90° 5mm x 123mm (1/4" x 4 7/8")	1
Q	45753A	Nerve Root Retractor 45° 8mm x 145mm (3/8" x 5 3/4")	1
R	SL45760A	Prong Retractor 75mm (3")	1
S	SL45761A	Prong Retractor 100mm (4")	1
	50000G	Instrument Case (23" x 11" x 3 1/2")	1

Open Posterior Lumbar System COMPONENTS

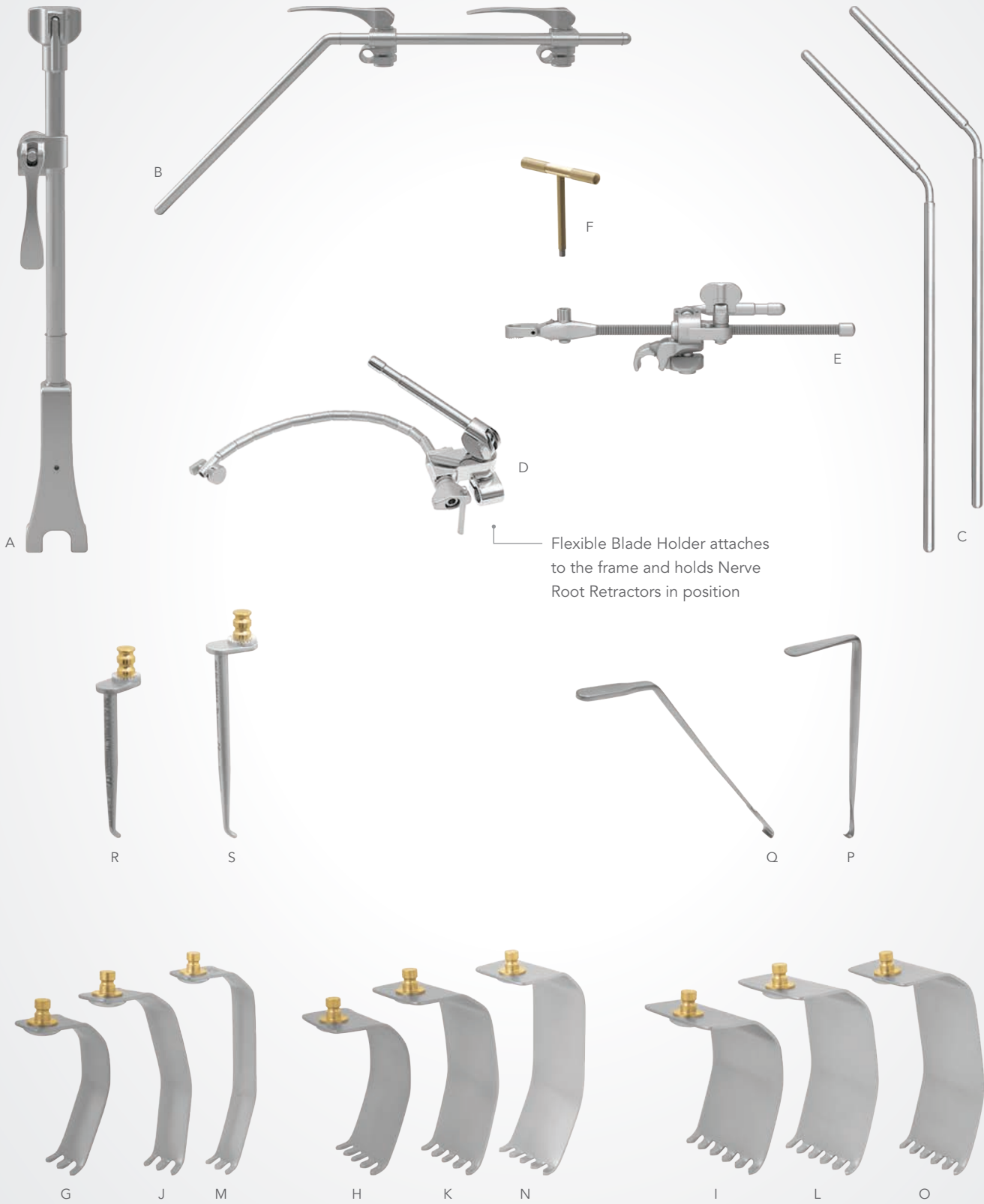

POSTERIOR LUMBAR