

## Lite Wand LED

### Add Bright LED Light to Procedures

The Lite Wand LED increases surgical exposure by adding bright LED light. Low profile by design, it easily clips to your retractor and operates at or below hand level, reducing shadows and often eliminating the need for headlights. The bendable gooseneck design and adjustable length direct light deep into cavities. All parts are fully reusable and come with a Thompson LED light source.



*Utilize the bright, reusable, Lite Wand LED to add illumination to any open surgical procedure with the Thompson Retractor.*

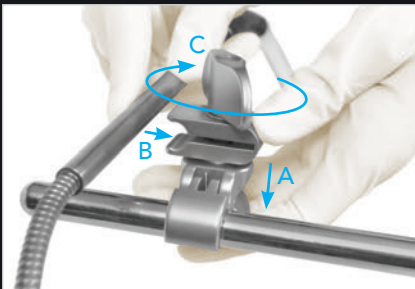

#### Attach

Attach joint to any 1/2" frame component where lighting is desired (A).

Clip the Lite Wand LED to the joint (B).

Secure in place by turning the knob clockwise to tighten (C).

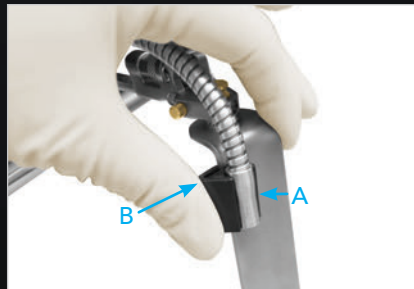

#### Lite Clip (optional)

Attach Lite Clip to distal end of Lite Wand LED, with the thin opening toward the back of the lite (A).

While applying pressure to the blade for leverage, slide the Lite and Lite Clip onto the desired blade (B). Push all the way onto blade to secure.

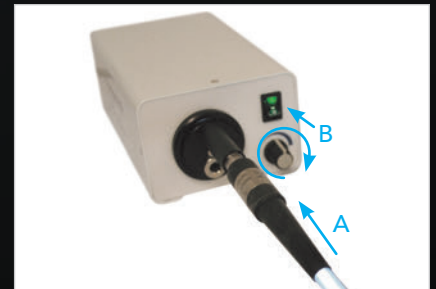

#### Light Source

Plug in the Lite Wand LED cable to the Thompson LED light source (A).

Turn on light source (B) and position the flexible neck of the Lite Wand LED as needed.



#### NOTE:

Lite Wand LED will only fit in the Thompson port (extended tip) on the light source turret. Second port is standard ACMI.

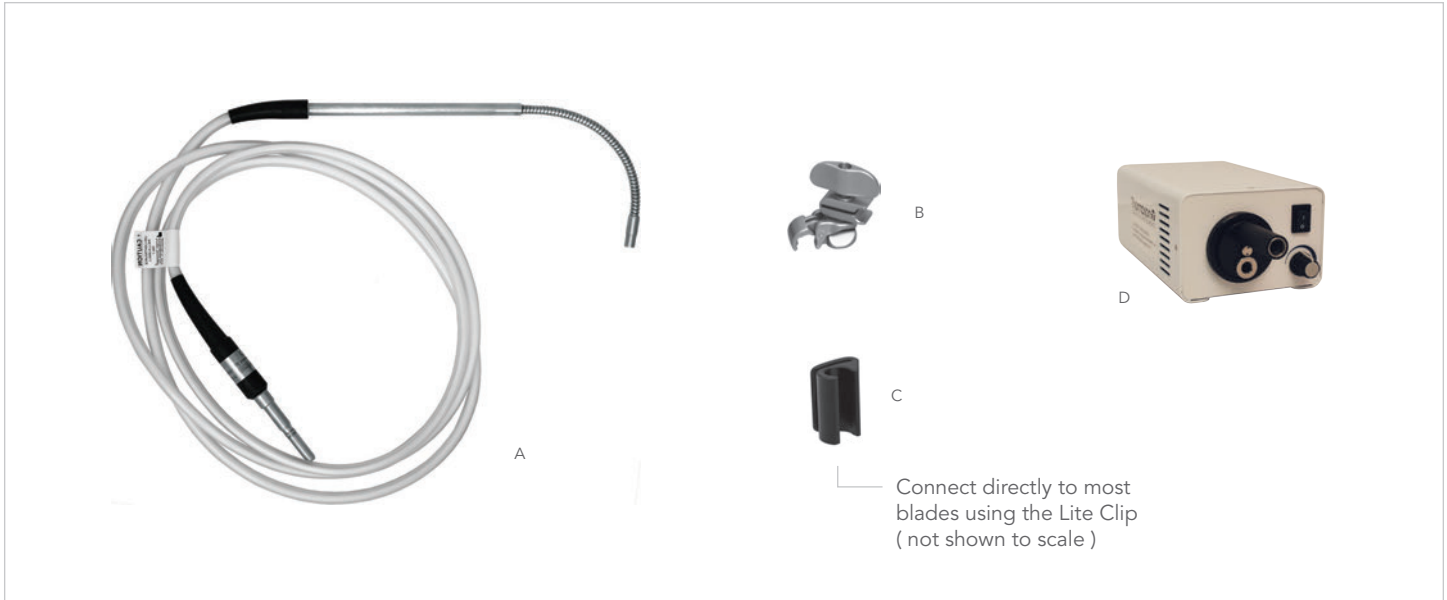

**LITE WAND LED KIT**

**#40001LWL**

REF	QTY	ITEM DESCRIPTION	PART #
A	1	Lite Wand LED	40002LWL
B	1	Universal Clip-on LW Joint 1/2" x 3/8"	42109NCP
C	1	Lite Clip ( Radiopaque )	40026

REF	QTY	ITEM DESCRIPTION	PART #
D	1	LED Light Source	LLS-2000-2
	1	Instrument Case	50000LW

**NOTICE:**  
Thompson light source is required for use of the Lite Wand LED. Light source contains dual ports: a custom port for the Lite Wand LED and a standard ACMI port.



Visit us online: [thompsonsurgical.com](http://thompsonsurgical.com)  
For a Free Trial Call **1-800-227-7543** \*

\* Free trial valid for U.S. customers only. Customers outside the U.S.A., please call +1-231-922-0177 for availability.

© 2017 Thompson Surgical Instruments, Inc. Traverse City, Michigan.

© S-Lock®, PLA®, and the Thompson "T Circle" logomark are Registered Trademarks of Thompson Surgical Instruments, Inc.  
Patents: US4971038, US5025780, US5888197, US5897087, US5902233, US5984865, US6033363, US6416465, US6511423, US7338442, US7749163, US8257255, US8360971, US8617064  
Other patents pending.

Lite Wand LED (40002LWL) and LED Light Source (LLS-2000-2) are manufactured by Sunoptic Technologies® and distributed by Thompson Surgical Instruments, Inc.

Rev B  
040517  
lwss0417

